

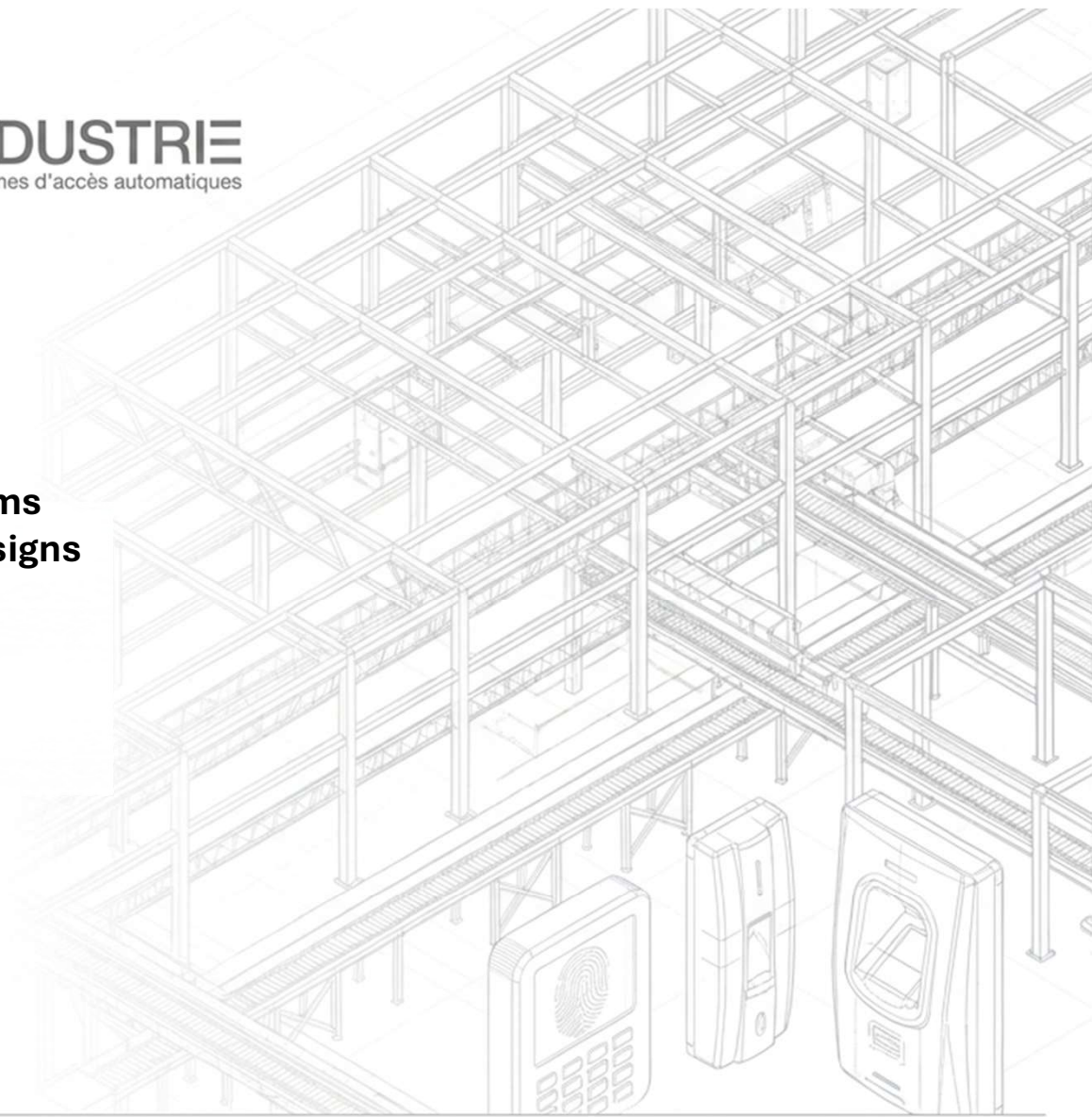

POWER MEETS PERFORMANCE

With over 20 years of expertise in automated systems engineering and access control, KIL INDUSTRIE designs tailor-made solutions for the most demanding infrastructures.

We orchestrate every stage of your projects, from strategic design to operational implementation.



58 Wilayas — National Presence

A Network of Global Leading Partners

KIL INDUSTRIE selects the very best in international engineering to guarantee the security and performance of your access points

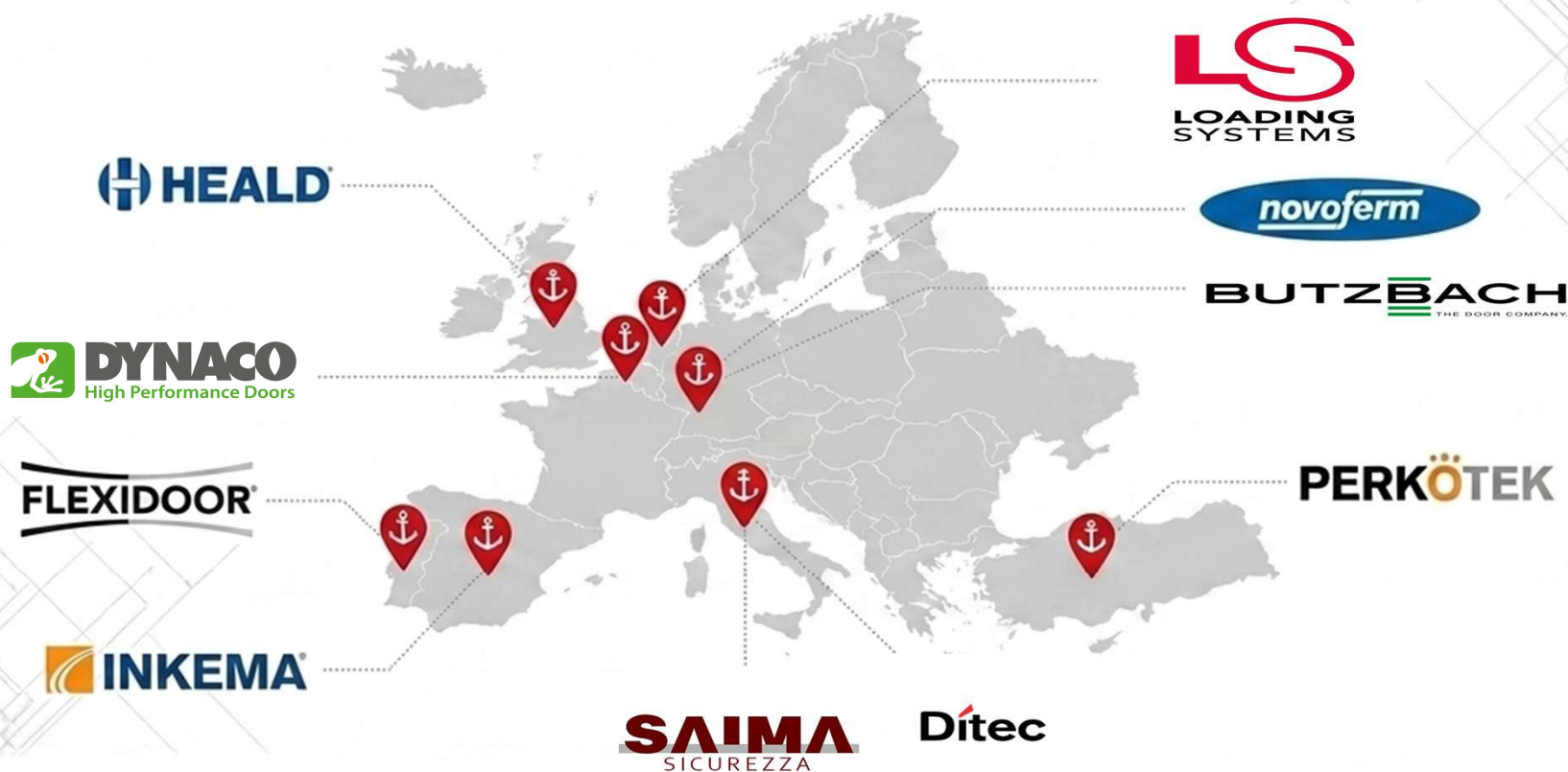

Exclusive official distributor and certified integrator meeting international standards (CE, NF, ISO, PAS68)

Why multiply points of contact when you can unify your entire access management?

- **Proven Civil Engineering:** From flow analysis to the civil engineering of dock pits, ensuring a frictionless integration.
- **Unified Ecosystem:** Electromagnetic compatibility and consistent operational logic across pedestrian, vehicle, and industrial access points
- **European Compliance:** EN 16005, EN 13241 standards, and Machinery Directive 2006/42/EC rigorously applied across the entire site.



Integrated Flow Architecture

A single partner to orchestrate your infrastructure's entire access system

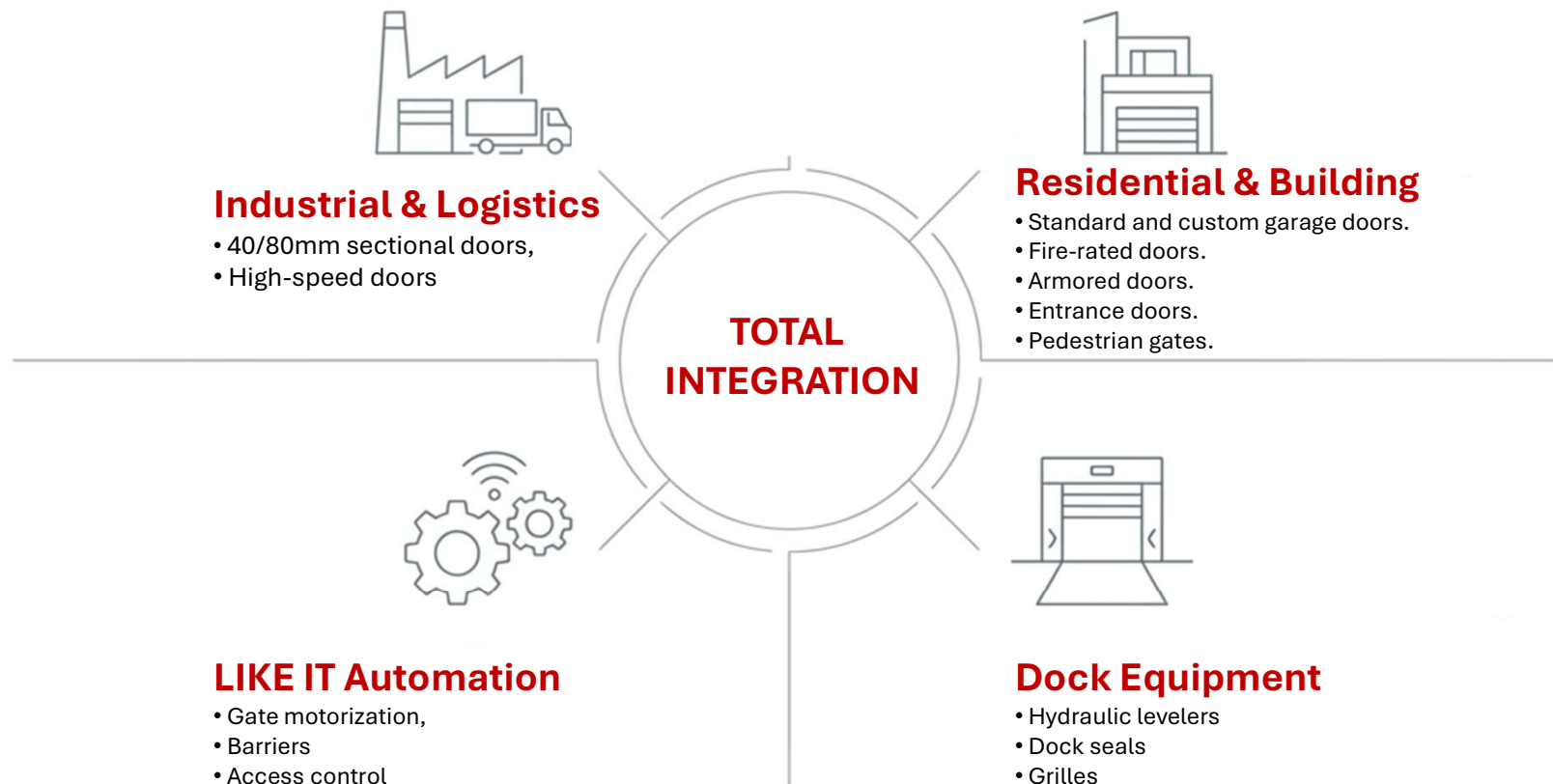

Applications & Expertise

- Temperature-Controlled Storage Zones
- Manufacturing Workshops & Factories
- Warehouses & Logistics Hubs
- Aircraft Hangars
- Shipyards

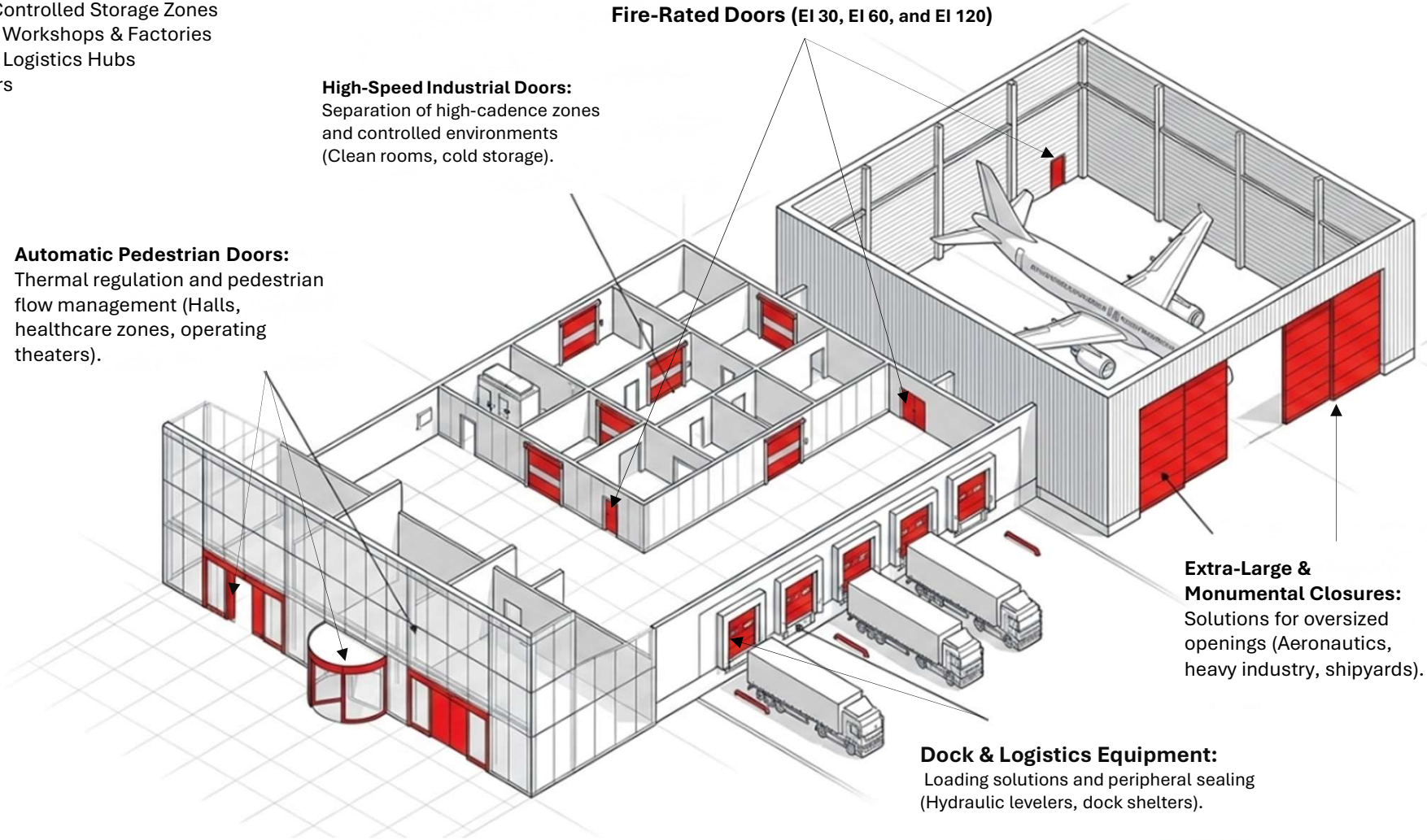

High-Speed Industrial Doors:
Separation of high-cadence zones and controlled environments (Clean rooms, cold storage).

Fire-Rated Doors (EI 30, EI 60, and EI 120)

Automatic Pedestrian Doors:
Thermal regulation and pedestrian flow management (Halls, healthcare zones, operating theaters).

Extra-Large & Monumental Closures:
Solutions for oversized openings (Aeronautics, heavy industry, shipyards).

Dock & Logistics Equipment:
Loading solutions and peripheral sealing (Hydraulic levelers, dock shelters).

The Health Ecosystem: Hospitals & Clinics

Where hygiene and safety standards meet our strongest solutions.

Medical Access Control

Secure airlocks and biometric readers. Strict protection for medication and narcotics storage areas.

Critical Care Zones

Automated hermetic doors. Strict maintenance of positive pressure for operating rooms and clean rooms (ISO 14644-1 Compliant).

Fire-Rated Doors:

EI 30, EI 60, and EI 120

Logistics Flow

Fast-acting roll-up doors. High-cadence separation for sterile transfer between differentiated hygiene zones.

Main Entrances

Automated sliding pedestrian doors (DITEC). Absolute thermal regulation and PRM compliance (Universal accessibility).

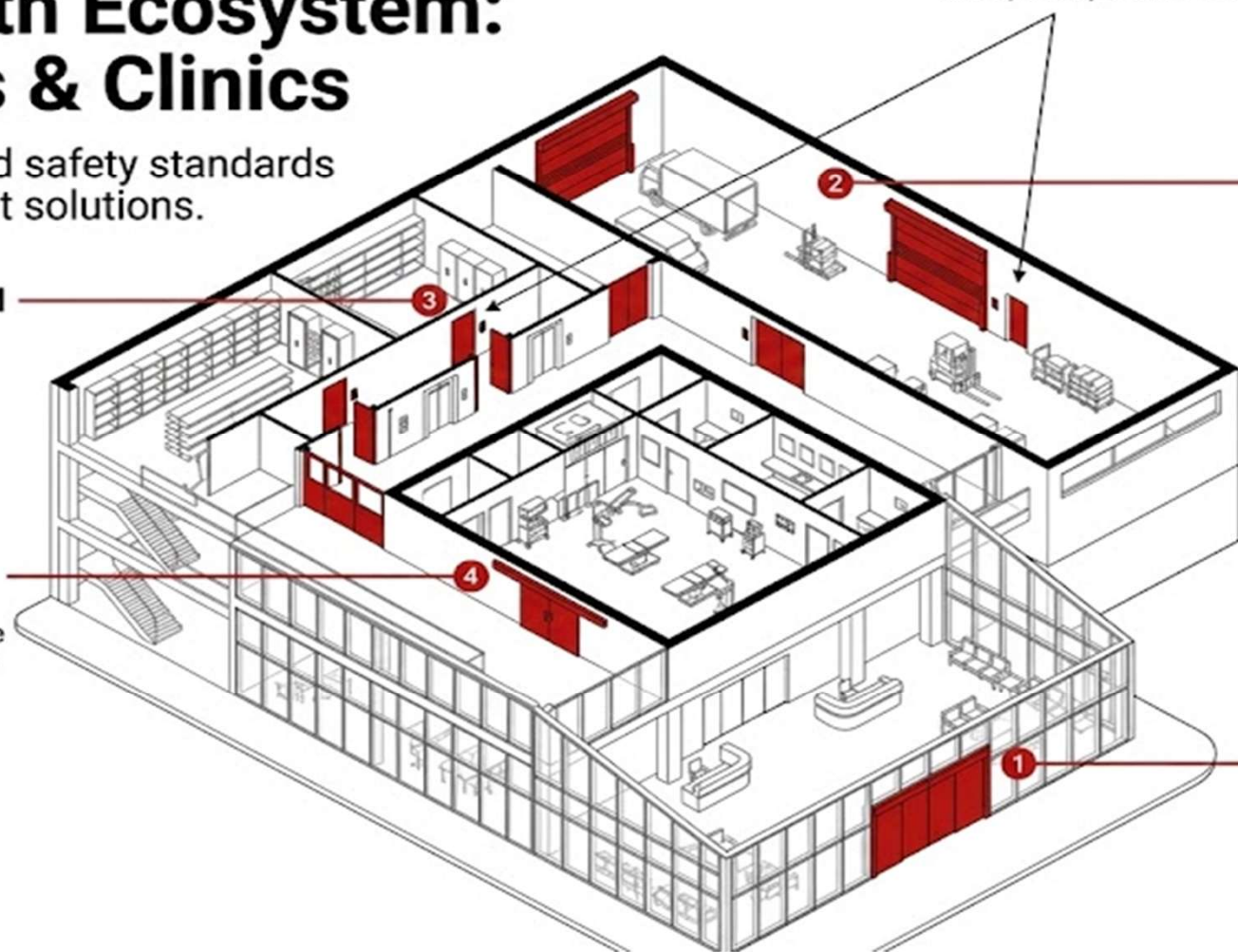

The Prestige & Corporate Ecosystem: Hotels, Offices & Luxury Real Estate

Fire-Rated Doors (EI 30, EI 60, and EI 120)

Refuge Zones

Discreet Self-Safe Rooms for suites and executive offices. Instantaneous protection.

Smart Building Comfort

Invisible motorizations (LIKE IT / DITEC).
Tailor-made solutions

Reception & Corporate Prestige

Revolving and telescopic glass doors. Silent and fluid design for lobbies and headquarters (DITEC Valor range).

Smart Parking & Perimeter Security

Aesthetic retractable bollards (Raptor) and barriers
Parking management with "Ultra-Shallow" foundations
ideal for urban real estate projects.

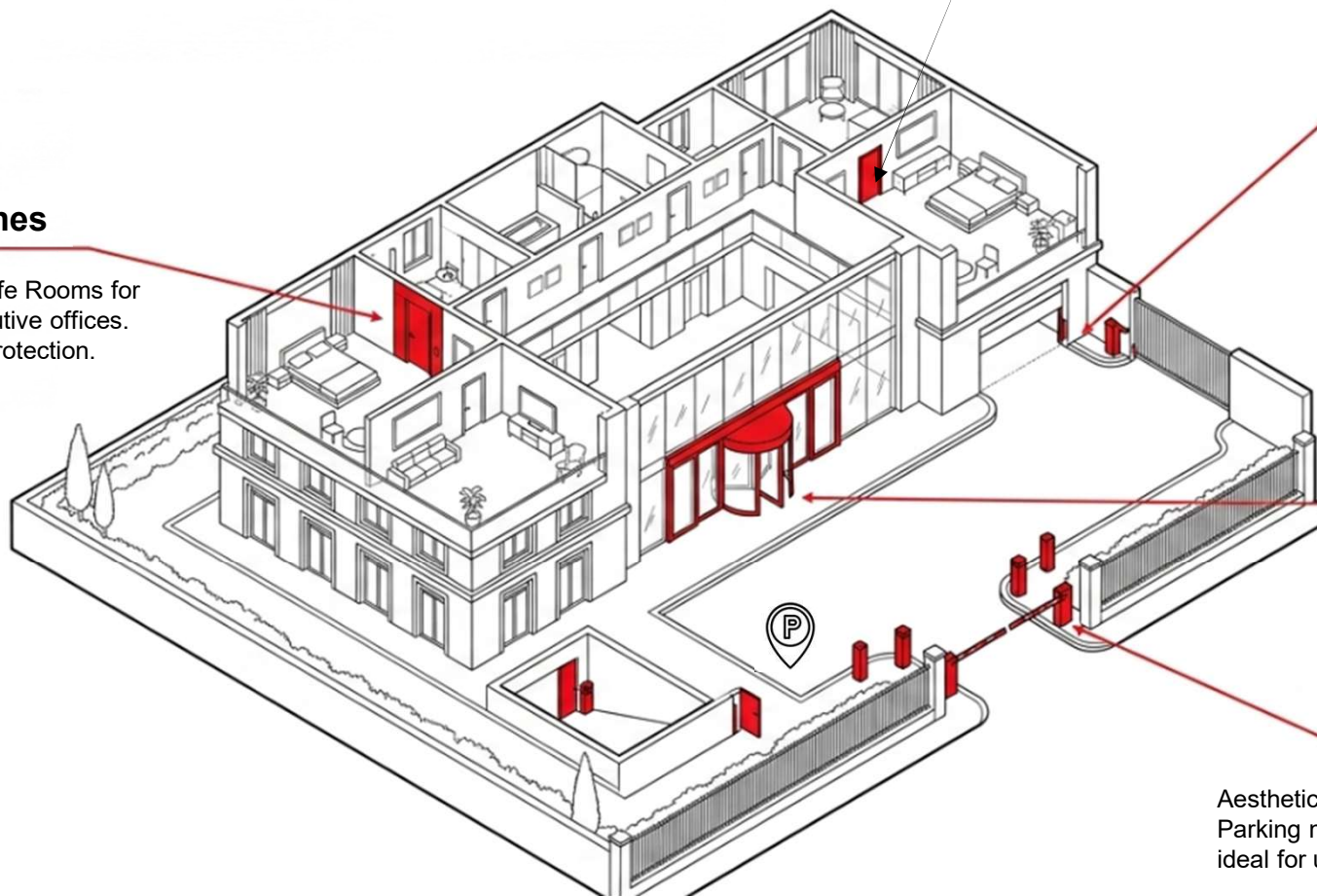

KIL INDUSTRIE
Systèmes d'accès automatiques

KIL Solutions: Industrial Gates

Equipments designed and manufactured locally to withstand heavy-duty use. A robust structure combined with custom flexibility, whatever your space configuration.



Model: Standard Sliding Gate

Manufacturing: Custom-made (Algeria)

Material: Robust galvanized steel

Finish: Choice of RAL powder coating

System: Fully automated

Maximum optimization of the back-run space. The ideal solution for wide entrances with restricted lateral clearance

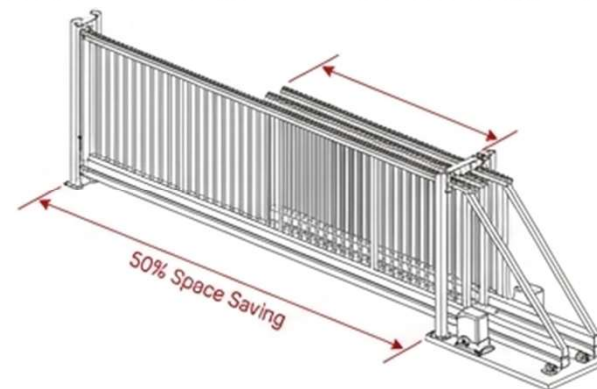

Model: Telescopic Sliding Gate

Performance: 50% footprint reduction

Material: High-resistance galvanized steel

Design: Synchronized leaves (custom-made)

System: Dedicated heavy-duty motorization

KIL Solutions: Pedestrian Access Control

Expert securing of human flows: from **impassable outdoor barriers** to **fluid and aesthetic control of interior spaces**



Model	Full-Height Turnstile
Security	Impassable barrier
Material	Galvanized steel structure
Finish	Varnished
Throughput	Person per cycle
Usage:	High-flow control (Outdoor



Model	Tripod Turnstile
Adaptability	Versatile use (Indoor / Outdoor)
Finish	Premium (Full polished stainless steel structure)
Control	Seamless RFID/Badge integration
Budget	Optimized security/cost balance

01 • OUR PRODUCTS

KIL Solutions: High-Speed Doors & Stainless Steel Speed Gates

Optimize your internal logistics flows and provide premium building access with our cutting-edge technologies.



Solution

High-Speed Doors

Compactness

High

Lifting

Advanced roll-up technology

Structure

Interchangeable curtain sections

Key Benefit

Maximum compactness for all access types



Solution

Stainless Steel Speed Gates

Chassis

Polished stainless steel frame

Control

Integrated biometric detection

Security

Visual obstacle and anti-intrusion alarm

Key Benefit

Regulatory compliance and high-end aesthetics



NOVOFERM.

Industrial Closures & Garage Doors
European quality for insulation and protection

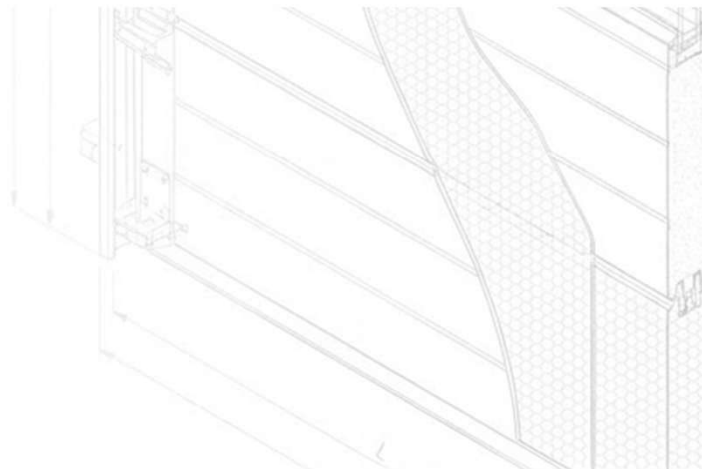

01 • IDENTITY & EXPERTISE

German rigor, validated for Algeria.

70



years of European
engineering and manufacturing

30 000

opening cycles tested
& validated by TÜV Nord

The 3 Pillars

1 SCHIEVANO

- The benchmark fire compartmentation, approved by Civil Protection DZ.

2 INDUSTRY

- High-performance sectional doors, high-speed doors, and docking equipment.

3 HABITAT

- Garage doors and collective parking for intensive flow.

[Certified Civil Protection DZ] [NF Certified] [CE Marking]

02 • SCHIEVANO RANGE

NovoPorta Premio Fire-Rated Doors



**«Absolute fire compartmentalization
– a mandatory condition for obtaining
your occupancy permit.»**

Maximum fire resistance and smoke containment for public buildings (ERP), stairwells, and basements. Direct connection to the fire alarm control panel.

1	Fire Resistance	EI₂30 to EI₂120
2	Material	Galvanized steel (Stainless steel available)
3	Control	Connected hydraulic door closer
4	Standards	EN 16034 / EN 1634-1 / EN 13501-2

CIVIL PROTECTION CERTIFIED

03 · INDUSTRY RANGE

Novodoor Thermo Sectional Doors



« *Maximum thermal sealing to secure your logistics platforms and cold chains.* »

High-density polyurethane foam panels designed to withstand extreme thermal amplitudes and strong winds, without compromising on durability.

1	Insulation (Thickness)	ISO 40, ISO 60, ISO 80 mm models
2	Thermal Performance (U)	Up to 0.8 W/m²K (80mm model)
3	Wind Resistance	Class 3-4 (Up to 1000 Pa / EN 12424)
4	Standard & Safety	[CE - EN 13241] / [TÜV Nord]

04 • HIGH-SPEED INDUSTRIAL RANGE

Novospeed Thermo Spiral Door



« The speed of logistics, the insulation of rigid doors. The best of both worlds. »

Contactless spiral roll-up technology. Unlike flexible doors, it offers extreme speed combined with anti-burglar security and a genuine thermal barrier with thermal break.

1	Opening speed	Up to 1.1 m/s
2	Reliability	200,000 tested cycles (springless)
3	Mechanism	Rigid lateral spiral
4	Insulation (U)	1.5 W/m²K (5x5m model)

05 • LOGISTICS & DISTRIBUTION

Hydraulic Dock Levelers & Shelters

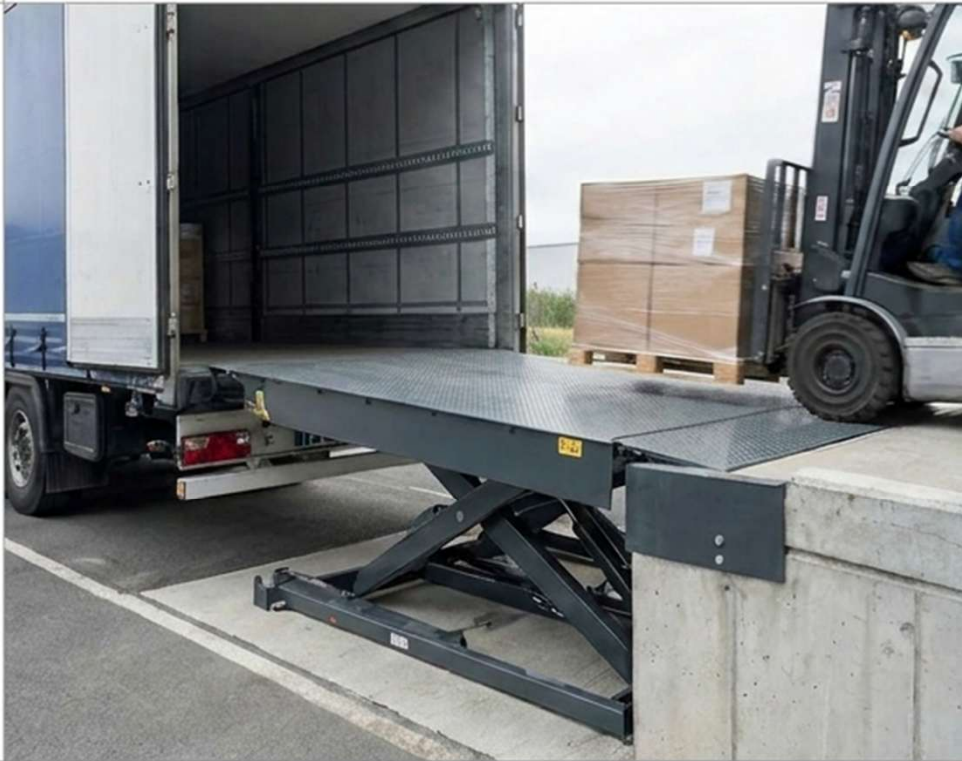

« *Fluid and secure transfers for ultra-high-intensity logistical flows.* »

Complete dock solutions integrating telescopic lip levelers for millimeter-precise adjustment, coupled with dock shelters for strict cold chain preservation.

1	Dynamic Capacity	6 Tons (60 kN)
2	Lip Technology	Telescopic (checker plate steel, 500mm extension)
3	Active Safety	Anti-leak system (Vehicle Creep Protection)
4	EU Compliance	[EN 1398]

06 · SELECTION GUIDE

The NOVOFERM Ecosystem by Application

	Public & Commercial Buildings (ERP)	Logistics & Cold Chain	Manufacturing & Production	Residential Parking
NovoPorta Premio (Fire Compartmentalization)	●	●	●	●
Novodoor Thermo 40/60/80		●	●	
Novospeed Thermo (High-Speed Spiral Doors)		●	●	
Dock Levelers & Shelters		●		

All installations are performed by certified KIL Industrie teams, guaranteeing strict compliance with the NF DTU 34.1 implementation standard.

Expertise & Systemes : HEALD.

High Perimeter Security. Certified protection of critical sites by KIL engineering.



HEALD: The Exclusive World Leader in HVM

HEALD

British engineering at the service of perimeter infallibility

Absolute Specialization

R&D is dedicated to Hostile Vehicle Mitigation (HVM). Zero industrial doors, zero compromises

British Engineering

Design, manufacturing, and testing carried out entirely in the United Kingdom according to the strictest global standards

Disruptive Innovation

Pioneer and undisputed world leader in Ultra-Shallow systems (ultra-shallow foundations)

KIL INDUSTRIE
Systèmes d'accès automatiques

The Only Metric That Matters: 0.0 Meters

Classification :

V/7500(N2)/64/90 : **0,0**

7.5-Ton
heavy truck

Blistering
impact speed
of 64 km/h

Perpendicular
strike (maximum
impact angle)

The vehicle is stopped dead. No debris, no advancement into your protected zone

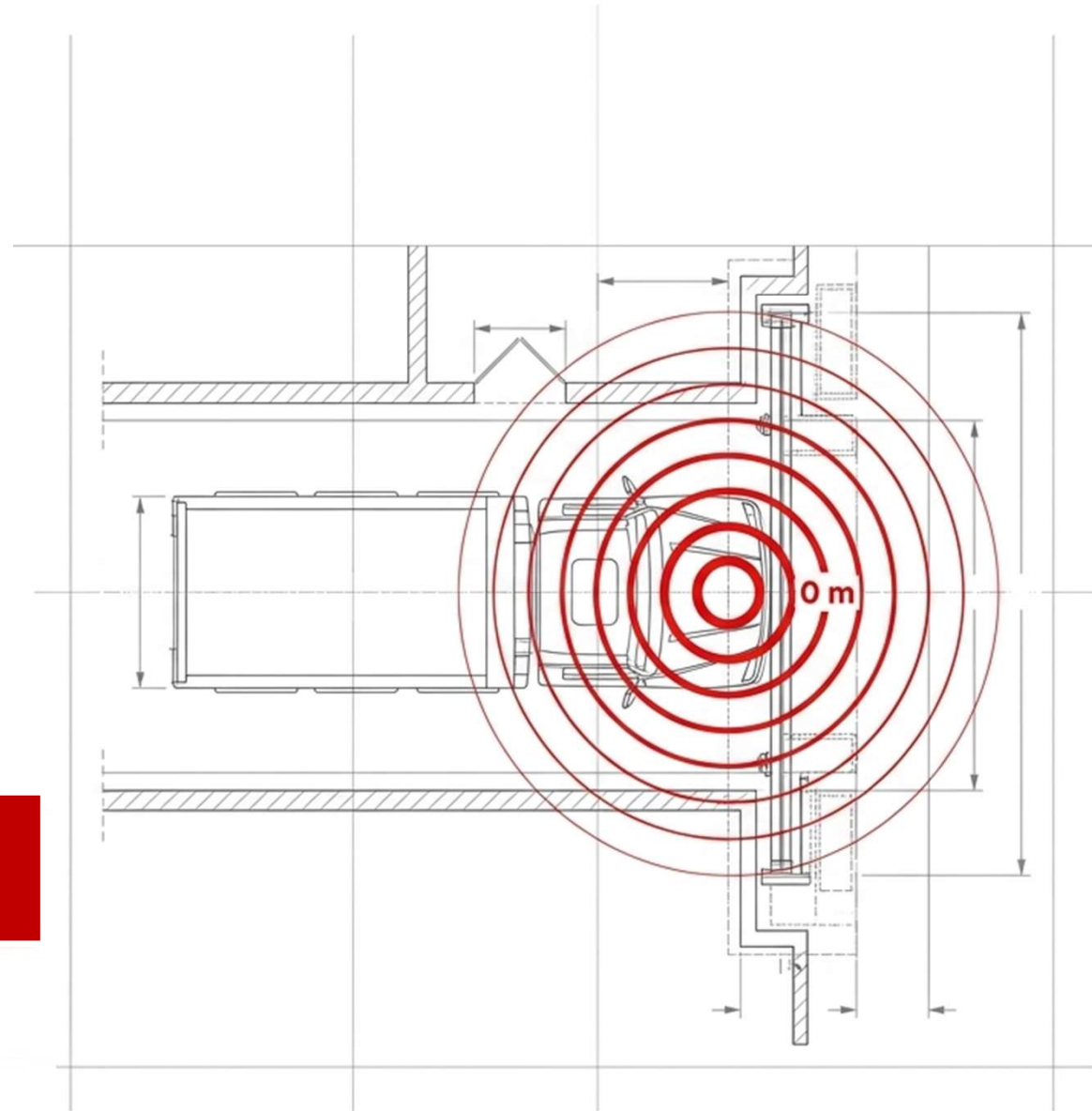

The Ultra-Shallow Advantage: Maximum Security, Minimal Civil Engineering

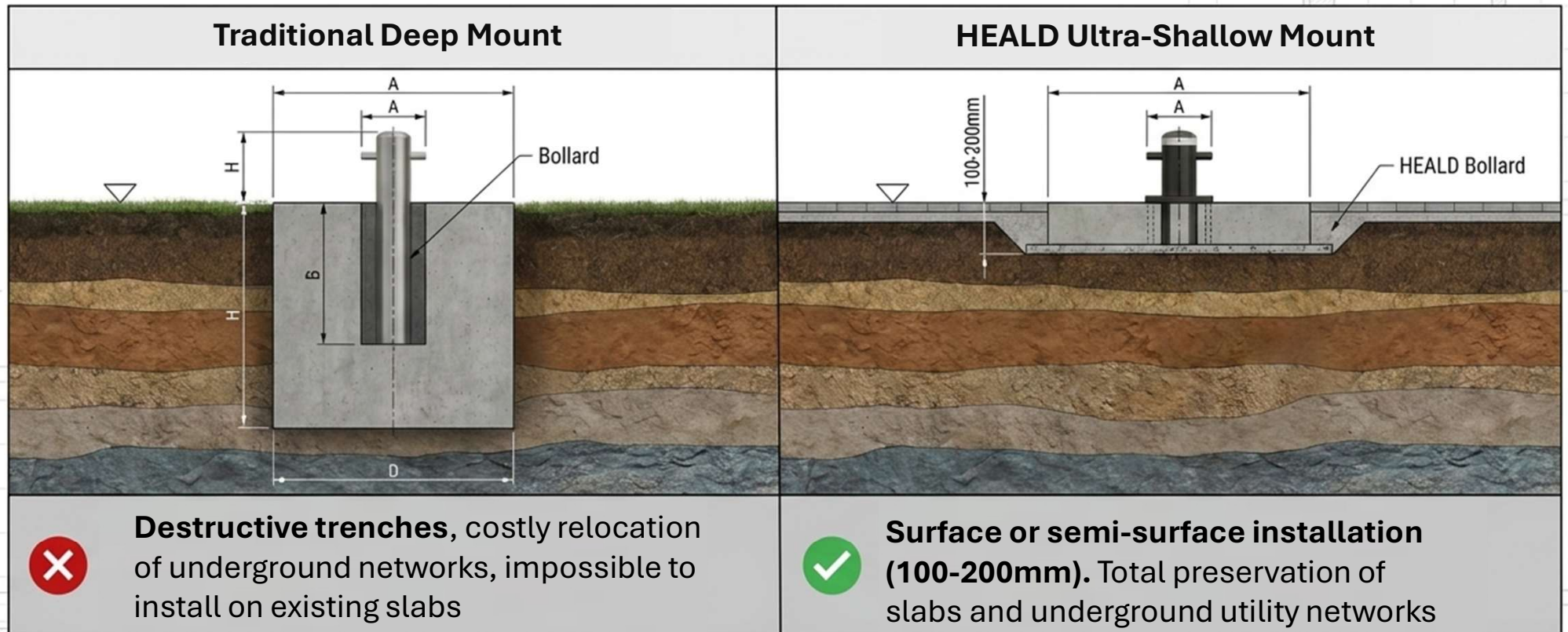

Crash-test certification (PAS 68 / IWA 14-1)

MATADOR: Maximum Security, Continuous Pedestrian Access

The Challenge: Protecting a roadway against hostile vehicles without creating a bottleneck for pedestrians

The MATADOR Solution: The patented innovation for uninterrupted pedestrian flow

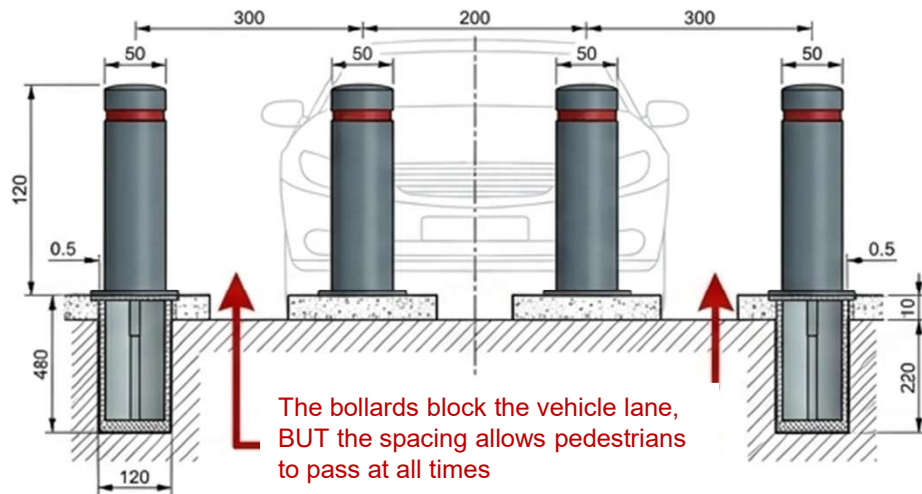

In Closed Position	In Open Position	Civil Engineering
<p>The bollards block all vehicles (Crash tested IWA 14-1: 7.5 T at 80 km/h). Calibrated spacing guarantees a fluid and permanent pedestrian flow, without any interruption</p>	<p>A world-first lateral retraction (sliding) to authorize vehicle access without lowering into the ground.</p>	<p>Absolute surface mounting on existing slabs (80 to 120 mm). Zero complex excavation</p>

VIPER: Post-Impact Operational Resilience

The Challenge: Most barriers secure against an attack but become out of service, leaving the perimeter vulnerable to secondary attacks. The VIPER Solution: The world's first certified shallow-mount road blocker capable of remaining fully operational immediately after a major impact.

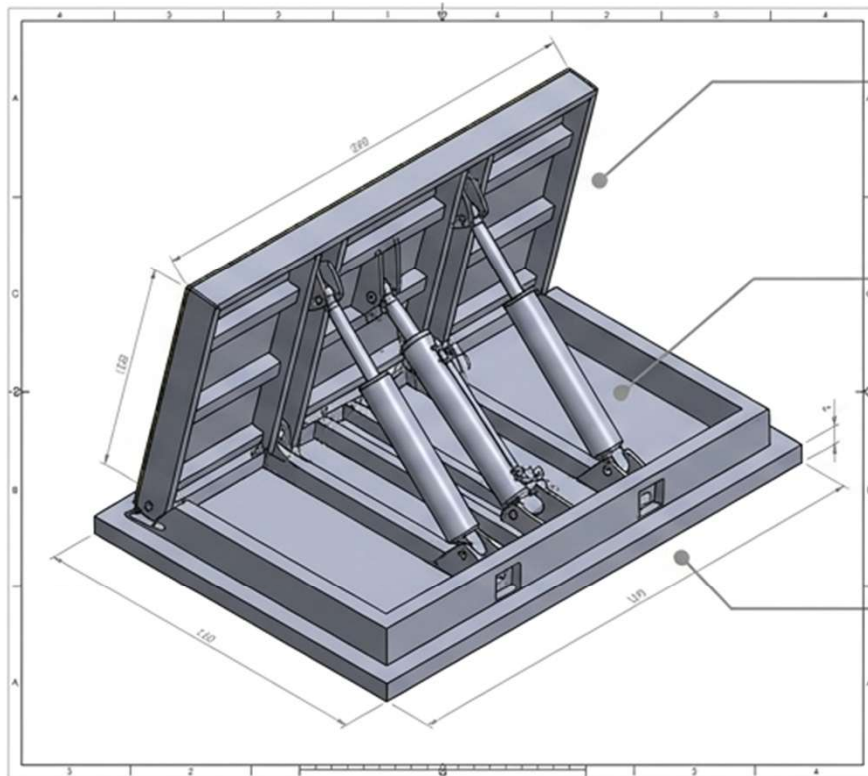

Certification: Dead stop of a 7.5 T truck at 80 km/h (PAS68)

Titanic Capacity: Supports the daily passage of heavy goods vehicles up to 30 Tons. Lowers and raises even after the destruction of the attacking vehicle

Installation: Rapid surface mounting, ideal for VIP access and private roads (3 to 4 meters wide)

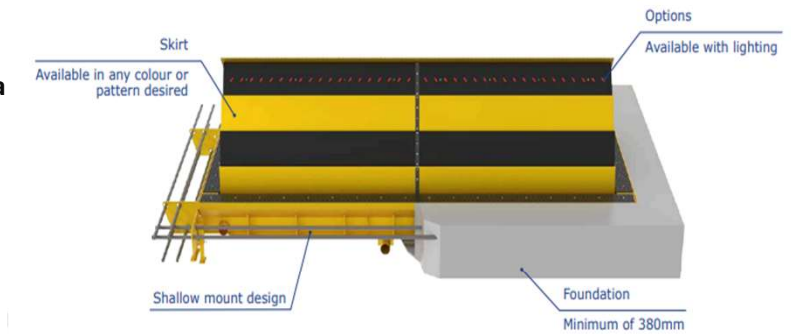

HT1 Raptor: Hybrid Bollard/Roadblocker Innovation

- **Revolutionary Design:** Unique concept combining the security of a roadblocker with the flexibility of a bollard
- **Infrastructure Protection:** Exceptional securing of underground networks and people
- **Modern Aesthetics:** Contemporary and distinctive design for successful architectural integration
- **Simplified Installation:** Shallow Mount technology facilitating installation without deep excavation
- **Post-Impact Resilience:** Unique on the market as it remains fully operational after a major impact.



Crash-Test: Dead stop of a 7.5T vehicle at 80 km/h
Certification: PAS68 (V/7500[N3]/80/90:3.3/18.9)
Reliability: Patented system, triple collision test validated

Height : 950 mm	Foundation : 480 mm
Operation : Electromechanical, Hydraulic, Manual	
Reaction : 1.5 seconds in emergency mode (EFO)	
Compatibility: Perfect integration with the HEALD static bollard range	

EVO: Urban Defense with Record Footprint

The Challenge: Installing high-security retractable bollards in dense urban environments saturated with underground utility networks

The EVO Solution: The world record for excavation depth for an automatic retractable bollard

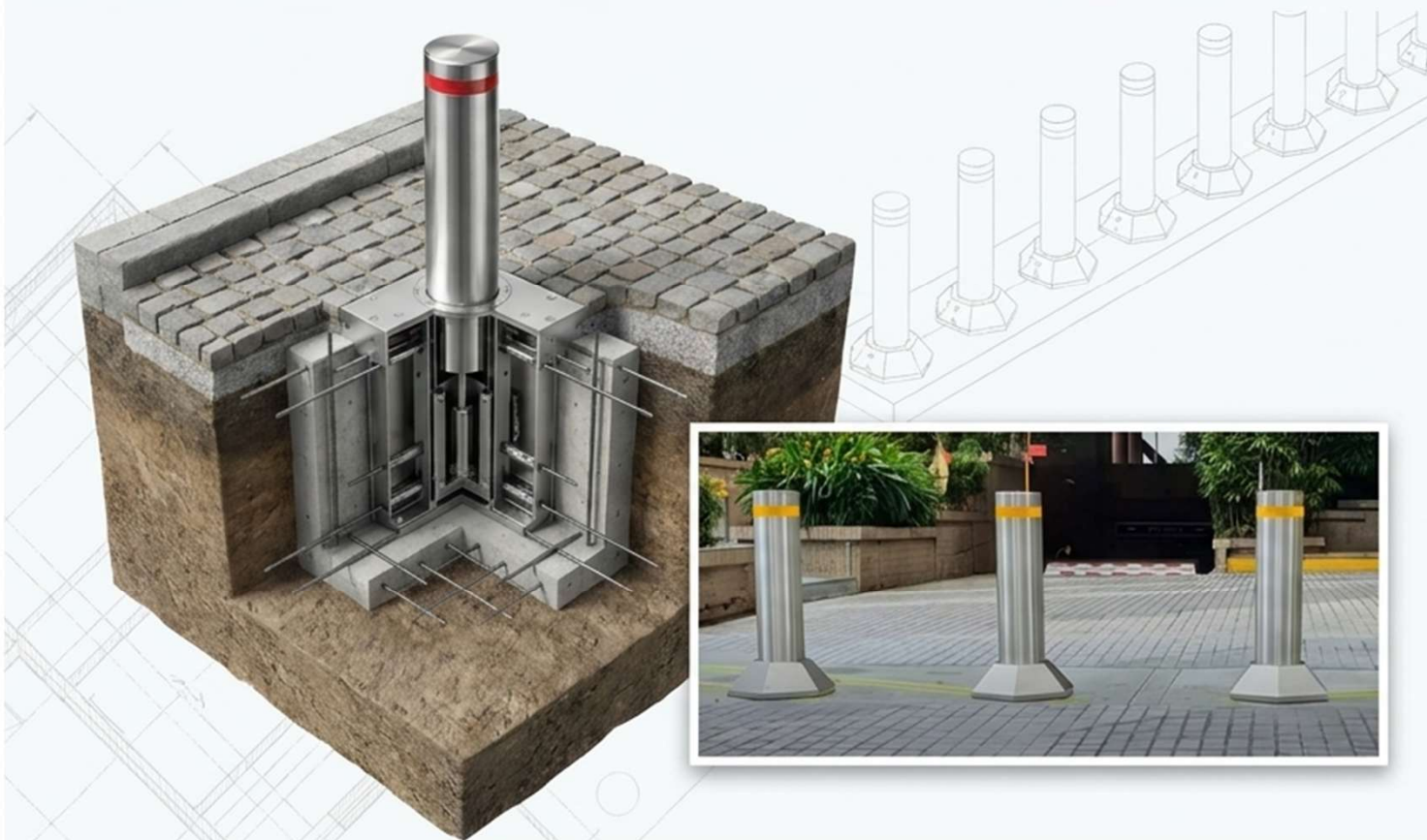

Excavation Depth

Only 1.1 m

(compared to the standard 2 to 3 meters)

Without disruption to existing utility networks

Infallibility

Zero penetration (0.0) against a 7.5 T vehicle at 64 km/h

Integration

Perfect harmony with residential roadways, urban pedestrian zones, and complex perimeters

Safety-Driven Architecture



MATADOR

Need: Security & High pedestrian traffic.

Depth: Pure Surface (80-120mm).

Mechanism: Lateral sliding.



VIPER

Need: Post-attack resilience & High heavy traffic

Depth: Shallow mount (Low)

Mechanism: Massive hydraulic lift



EVO

Need: Retractable & Complex urban underground

Depth: 1.1m (Record for retractable bollards)

Mechanism: Automatic rising

KIL
INDUSTRIE

Ditec
ENTRE/MATIC

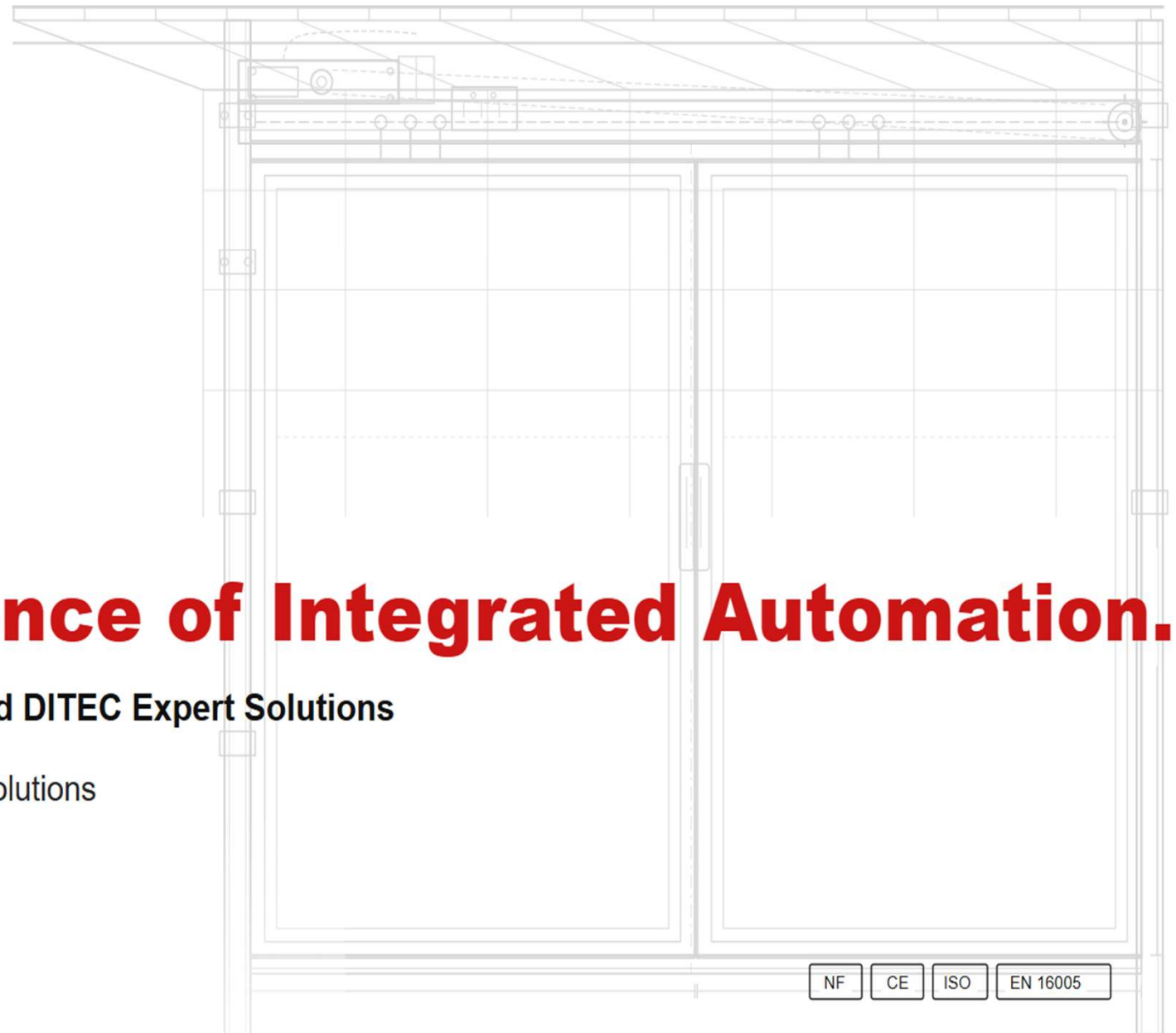

The Excellence of Integrated Automation.

The Purity of Engineering and DITEC Expert Solutions

The catalogue of DITEC expert solutions
distributed by KIL Industrie.

58 Wilayas — National Coverage

NF CE ISO EN 16005

DITEC VALOR & DAS200

“Entrance hall excellence:
silence, fluidity, and prestige
for your most demanding
access points.”

+ 1,000,000 CERTIFIED CYCLES

Versions:	Sliding, Bi-parting, Telescopic, All-glass
Motorization:	Electromechanical with toothed belt
Safety:	Integrated multi-zone radar detection
Certification:	EN 16005 / Machinery Directive



DITEC VALOR HH

- 4-Sided Hermetic Seal (Vertical & Horizontal Compression)
- Integrated Anti-Static Hygiene
- Advanced Multizone Safety Sensors (Stretcher-safe)
- Anti-Vibration Maximum Silence
- Heavy-Load Capacity for X-Ray Rooms

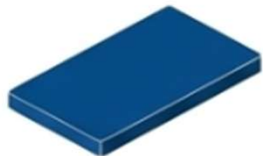

RAL Palette



Anodized Textures



AISI 304 Stainless Steel



02 · PEDESTRIAN SWING DOORS (ERP)

DITEC DAB105 & HA8 SERIES

Universal accessibility and absolute security:
the guarantee of infallible fire compartmentation.

PMR COMPLIANT **EI 30 to EI 120**

Capacity :	Leaf up to 100 kg
Fire-Rated (DAB105) :	EN 1634-1 certified (linked to fire panel)
Low Energy (HA8) :	Force limited to 67 N (Disability / PMR)
Certification :	EN 16005



DITEC CUBIC, PWR & ARC

Invisible integration for prestigious sites.
Power that fully preserves the aesthetics
of your facades.

UP TO 5 METRES PER LEAF

Ditec CUBIC (Buried): Mechanism invisible underground

Ditec PWR (Actuators): Sleek design for heavy leaves

Ditec ARC (Articulated arm): Operator for wide pillars

Standards : EN 13241 / EN 12453



04 · SLIDING GATE AUTOMATION SYSTEMS

DITEC CROSS & SECTOR

Controlled industrial power: move the heaviest gates with unwavering reliability.

2 500 KG (Max Capacity)

Usage :	Residential, Tertiary and Heavy Industrial
Drive :	Electromechanical pinion-rack, galvanised steel
Safety :	Photocells, sensing edge, absolute encoder
Resistance :	Sealed aluminium housing IP44 to IP54



KIL INDUSTRIE
Systèmes d'accès automatiques

DITEC QIK & SPID BARRIERS

Smooth and ultra-secure management of high-traffic car parks.

UP TO 6 METRES CLEARANCE

Usage frequency :	Very high traffic (CE certified)
Kinematics :	Fast, silent, dampened movement
Integrated controls :	RFID badge, inductive loop, IP intercom
Safety :	Anti-shock articulation, illuminated boom

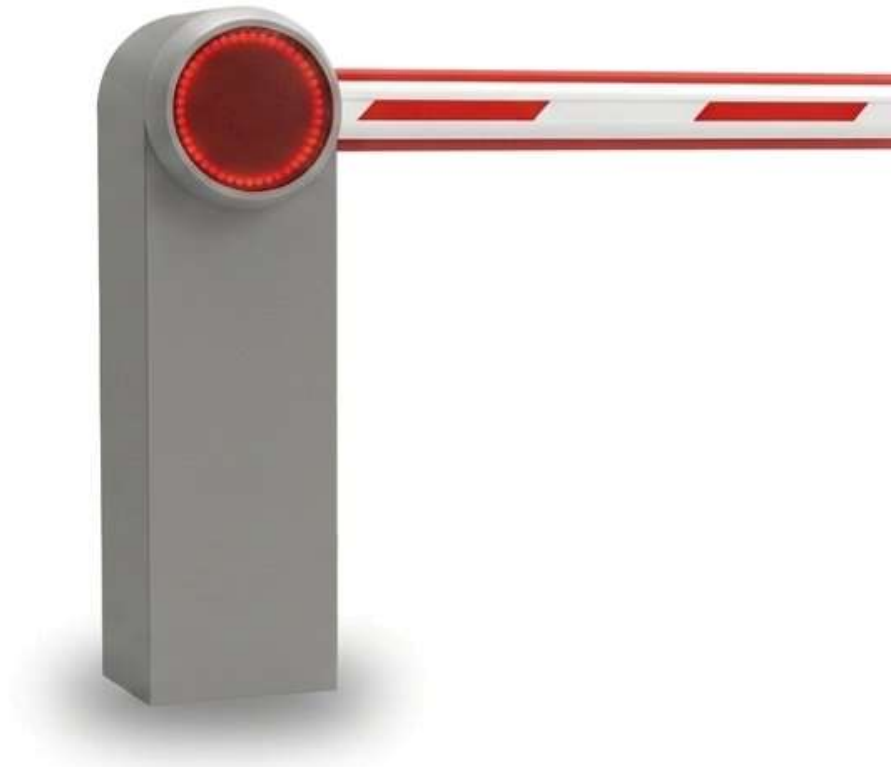

06 · FAST SOFT-ROLLING DOORS

DITEC TRAFFIC PRO & MASTER

Optimise your logistics throughput with ultra-fast, airtight zone separation.

Curtain type :	Reinforced flexible PVC with interchangeable sections
Environment :	Intensive interior or Exterior (Facades)
Cold version :	Configurations for climate control (Cold rooms)
Standard :	EN 13241 / CE Marking



KIL INDUSTRIE
Systèmes d'accès automatiques

DITEC SMART CONNECT

Total control of all your access points at your fingertips, wherever you are.



Mobile App:

Remote opening, alerts and access history.



Geofencing:

Automatic vehicle approach detection.



Smart Home:

Compatible with Google Home, Alexa and Apple HomeKit.



HD Video:

Integrated camera and cloud intercom.



KIL INDUSTRIE
Systèmes d'accès automatiques

DYNACO

Expertise & Systems: DYNACO.

Industrial High-Speed Doors.
Patented technology for
productivity and operational safety.

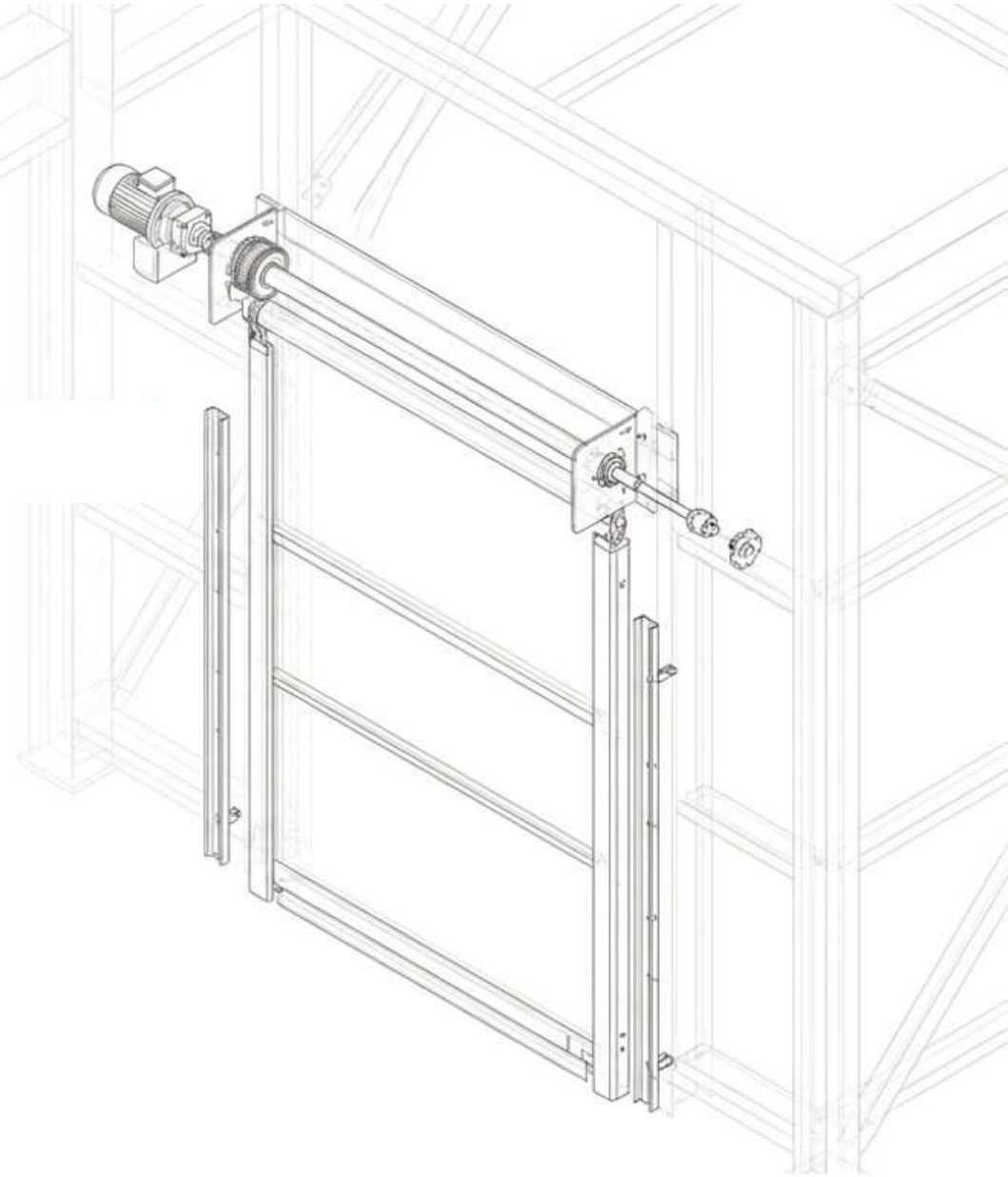

The Exclusive Leader: Technology **Zero Downtime**

"Push-Pull" Technology:

A patented counterweight-free system. Fewer mechanical parts, minimal wear, maximum durability.

Automatic Reinsertion:

In the event of an impact, the curtain exits its guides and automatically reinserts on the next cycle.

**Zero technical intervention.
Zero downtime.**



Accidental Impact



Automatic Reinsertion



Complete Restoration

Intensive Indoor Environment

Zero downtime and total operator protection thanks to the Soft Edge flexible border and automatic post-impact reinsertion.

Opening speed:	Up to 2.5 m/s
Wind resistance:	Class 0 to 2 (EN 12424)
Tested durability:	> 250,000 cycles (before maintenance)

DYNACO Safety Standard:
Integrated Soft Edge lower border.



Outdoor Environment & Facades

ROI Argument: Guarantee the airtightness of your buildings and streamline your logistics flows, even in extreme winds.

Opening speed: 1.2 to 2.0 m/s

Wind resistance: **Class 3 to 4** (up to 1000 Pa)

Airtightness: Reinforced (Class 2 EN 12426)

Curtain: Reinforced PVC fabric

DYNACO Safety Standard:

Integrated Soft Edge lower border.



Cleanrooms & Agro/Pharma

Master your pressure cascades with absolute sanitary airtightness and a wash-down compatible washable frame.

Certification: ISO 14644-1 compliant (Class 4)

Opening speed: Up to 2.5 m/s

Materials: Composite frame or Stainless Steel 316L

Airtightness: Sanitary seals, controlled air leakage rate



Cold Chain & Sub-Zero Freezer ROOMS

ROI argument: Stop thermal losses and eliminate frost formation with cryogenic heated-rail technology.

Max temperature:	Up to -30°C
Opening speed:	1.0 m/s minimum (maintained at low temp.)
Technology:	Heated side rails (anti-frost)
Curtain:	Flexible PVC with cryogenic properties

DYNACO Safety Standard: :
Intearated Soft Edae lower border. égrée.



Diagnostic Selection Matrix

Find the exact kinematics adapted to your industrial flow requirements.

Model	Key Advantage	Max Speed	Wind Resistance	Target Environment
Indoor	Zero Downtime	2.5 m/s	Class 0-2	Logistics
Outdoor	Maximum Airtightness	2.0 m/s	Class 3-4	Facades
Cleanroom	Sanitary Compliance	2.5 m/s	Class 0-2	ISO Class 4
Cold	Anti-Frost	1.0 m/s	Class 0-2	Up to -30°C
Rigid Spiral	Safety & Insulation	1.5 m/s	Class 4-5	Sensitive Access

EXPERTISE & SYSTEMS

Secure Access Engineering.
High-performance filtering solutions
and anti-robbery airlocks.



Italian Excellence in the Service of Infallibility.

Since 1977, SAIMA Sicurezza has been the undisputed leader in high-security access control. Historically dominant in the banking sector with our anti-robbery airlocks, we have combined maximum ballistic resistance with the architectural elegance of Italian design.



Banking Heritage:

+40 years of leadership in critical-risk environments.



Native Integration:

Biometrics, RFID, metal detection and behavioural analysis.



Pininfarina Design:

Invisible security and seamless integration for corporate headquarters.



Anti-Robbery Airlock with Electronic Interlock.

The ultimate bulwark for your branches: absolute individual filtering coupled with infallible weapon detection.

Diagnostic Table	
Target Environment:	Banks, Jewellers, Confidential Areas
Filtering:	Electronic interlock & Anti-tailgating (weighing)
Detection:	Integrated multi-zone walk-through metal detector
Glazing Rating (Glass):	High Security classified BR1 to BR7 (EN 1063)
Burglary Class:	EN 1627 compliant



From the Anti-Robbery Airlock to the outer perimeter: the SAIMA shield covers 100% of your security levels.

Full-Height Turnstiles: Impassable Perimeter Control

An anti-climb barrier designed for unsupervised environments, combining absolute physical deterrence and climatic endurance.

Target Environment	Stadiums, Industrial sites, Sensitive perimeter zones
Architecture	AISI 304 stainless steel or galvanised structure
Profile	Deterrent height up to 2400 mm (Anti-climb)
Kinematics	Robust central rotor with 3 or 4 sectors
Throughput	High capacity: 15 to 25 persons / minute



The Promise of Infallibility: Beyond solid steel, it is the reliability of its mechanical core that defines this turnstile. Designed to withstand the most extreme climatic conditions without the slightest failure, it guarantees strict 24/7 filtering with near-zero maintenance requirements.

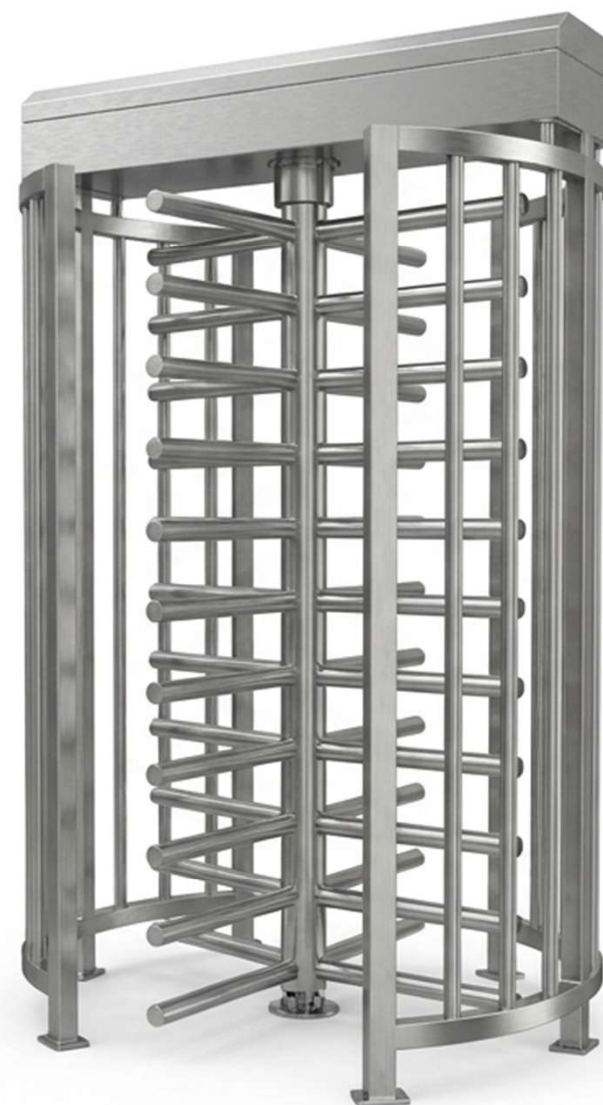

KIL INDUSTRIE
Systèmes d'accès automatiques

Tripod Turnstiles: Smooth Interior Flow Management

The perfect balance between budget rationalisation, technological integration and strict compliance with evacuation standards.

Target Environment	Reception halls, Sports venues, Tertiary entrances
Mechanism	Ultra-smooth 120° single-arm mechanical rotation per cycle
Finish	Polished stainless steel (Clean, durable design)
Security Integration	Native compatibility with RFID and biometric readers
Critical Safety (Fire)	Fail-Safe Technology* : Integrated emergency unlocking

Precision Mechanics & Vital Safety: Designed for intensive use, the internal mechanism guarantees millions of cycles without wear. In the event of a power cut or fire alarm, the Fail-Safe system triggers automatic arm release, instantly clearing the path for panic evacuation without any obstacle.



Speed Gates & Optical Lanes.

The perfect fusion between Italian architectural design and high-surveillance passage fluidity.

Diagnostic Table

Target Environment	Corporate headquarters, Data Centres, Premium lobbies
Throughput	Very high throughput, up to 60 pers/min
Anti-Fraud Security	3D optical sensors, strict Tailgating detection
Drive	Retractable or bidirectional pivoting leaves
Certification	EN 16005 safety of use compliant



Motorised Armoured Doors.

Architectural discretion concealing an impenetrable ballistic and burglar-proof shield.

Target Environment	Embassies, Ministries, Vault rooms
Burglary Class	Certified RC2 to RC6 (EN 1627 standard)
Glazing Rating	Certified BR1 to BR7
Kinematics	Motorised sliding or roto-translative (wide PMR opening)
Critical Function	Double security interlock configuration



Self-Safe Room (Refuge Zone)

Immediate executive protection: instantly transform an open space into a ballistic fortress.

Target Environment	VIP offices (Executives), Strategic crisis rooms
Concept	Retractable armoured walls for instant shelter
Glazing Rating (Glass)	Bulletproof and anti-spall glass BR4 to BR7
Burglary Class	Panels and doors RC4 to RC6
Energy & Survival	UPS autonomy (minimum 4h in case of power cut)



Intelligence Around Armour

SAIMA solutions are not simple physical barriers. They integrate **natively** to the strictest **identification systems** and supervision on the market (Wiegand, OSDP, TCP/IP).



Advanced Biometrics: Fingerprint, facial recognition, iris scanning.



Classic Identification: RFID, magnetic badges, secure QR Codes.



Behavioural Analysis: Anti-tailgating weight sensors and SecurFlow technology (3D cameras detecting tailgating or abandoned objects).

Expertise & Systemes : BUTZBACH

Special Industrial Doors. XXL access solutions for hangars and complex architectures

Spacelite Tilting Doors

Flood your workshops with natural light while eliminating overhead clutter.

78%

Maximum light transmission

Material	Double-skin fibreglass panel (Thickness 40 to 150 mm)
Kinematics	Vertical stacking without ceiling rails
Insulation	U-coefficient up to 1.0 W/m ² K
safety	RC3 anti-burglary certification available

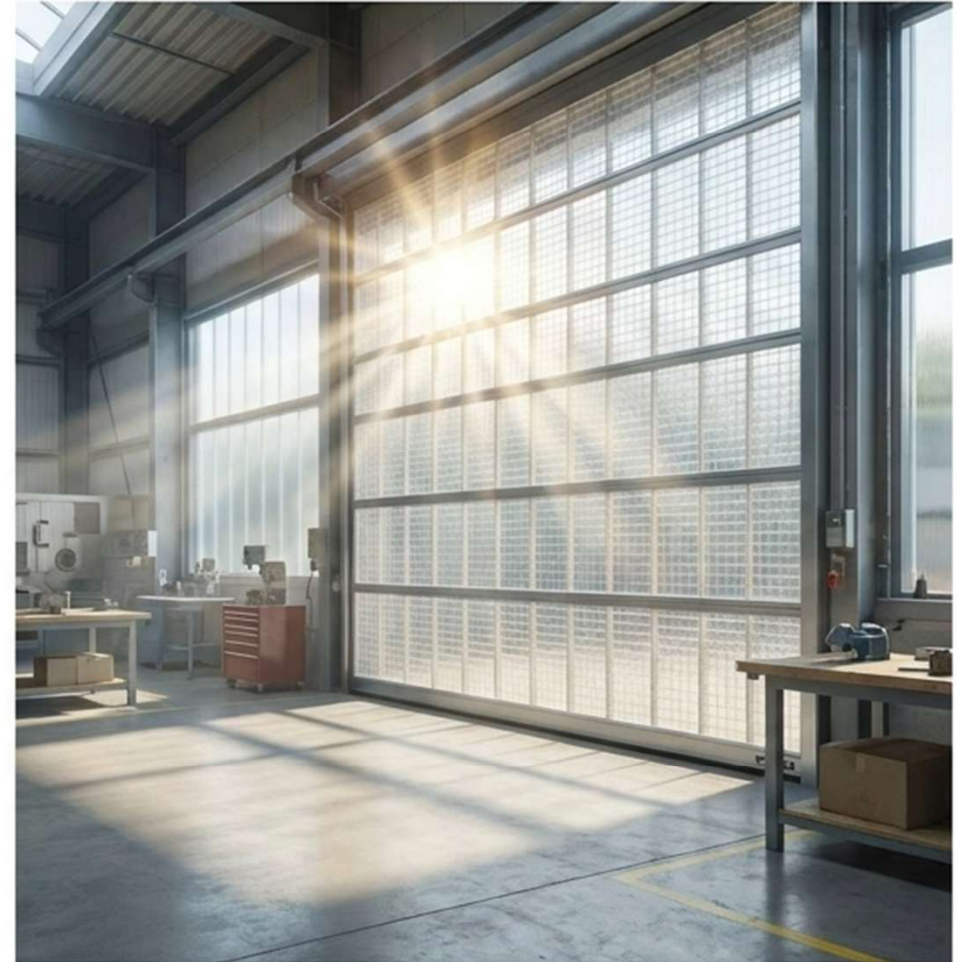

Sectiolite Sectional Doors

The perfect alliance between exceptional thermal insulation and architectural integration under extreme constraints.

350 mm

Ultra-compact lintel clearance

Thermal Resistance	Exceptional U-coefficient up to 0.82 W/m ² K
Climate Resistance	Storm Class (up to Force 12 / Hurricane)
Performance	Fast opening speed up to 1.5 m/s
Design	Panoramic real glass option without glazing bars



Novosprint High-Speed Doors

Streamline your logistics processes at lightning speed with absolute anti-collision safety.

5 m/s

Blazing lateral opening speed

Kinematics	Horizontal lateral opening (Syncro / Mono / Duo)
Active Safety	Immediate release preventing forklift collisions
Integrated Backup	Elastic force opening in case of power cut (DGUV compliant)
Endurance	Manufacturer warranty of 500,000 cycles

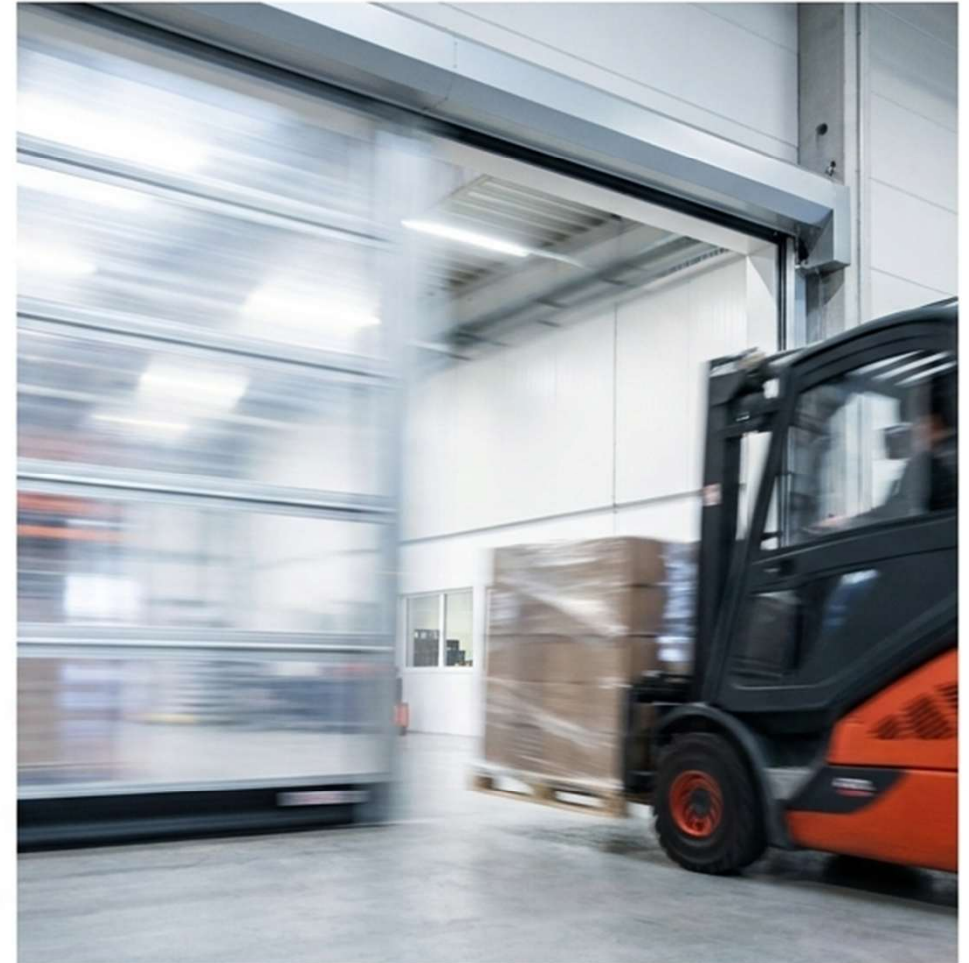

Hangars & Aviation



Permanent operational availability (24/7)
combined with monumental dimensions
bathed in light.

100+ m

Extreme custom-span openings

Design	Complete project engineering (from sketch to handover)
Material	High climate-resistant fibreglass composite fabric
Compliance	Integrated emergency exits certified TÜV SÜD
Availability	Redundant systems for 24/7 critical operations

Architectural Synthesis Matrix

	Spacelite	Sectiolite	Novosprint	Aviation
Maximum Natural Light	✓			✓
Extreme Speed & Intensive Traffic			✓	
Space Constraints / Reduced Headroom		✓	✓	
Superior Thermal Efficiency		✓		
Monumental Dimensions	✓			✓

KIL INDUSTRIE
Systèmes d'accès automatiques

One range, four absolute solutions to modern industrial constraints.

Sectional Doors & Automations.

Robustness and design for residential and industrial access.

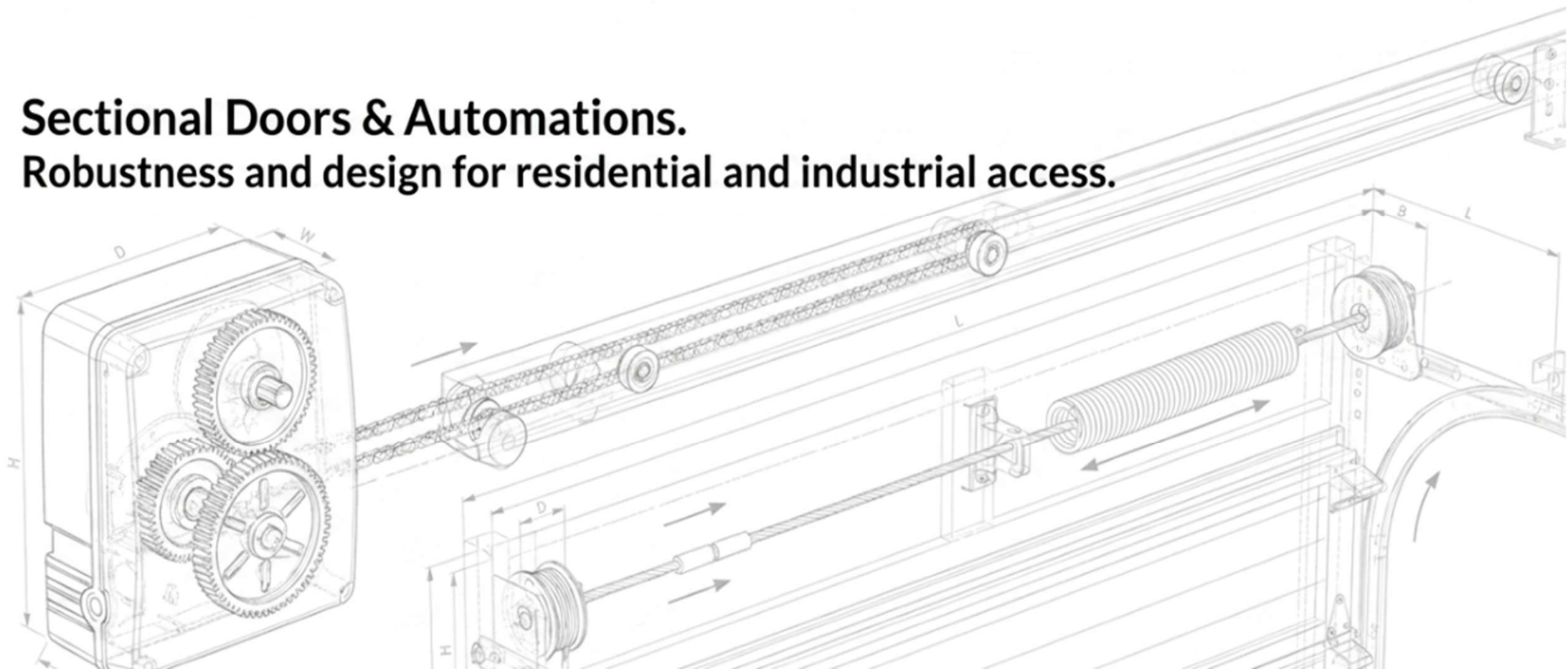

INDUSTRIAL SECTIONAL DOORS: THE LOGISTICS REFERENCE

Thermal and mechanical engineering designed for your most demanding flows.

Specification	Standard	Thermal Requirement
Thickness	40 mm	80 mm
Insulation (Coef. U)	1.3 to 1.5 W/m ² K	0.8 to 1.0 W/m ² K
Wind Resistance	Class 2/3 (EN 12424)	Class 2/3 (EN 12424)
Lifting Options	Standard, Vertical, Low lintel	Standard, Vertical
Standard	EN 13241	EN 13241



RESIDENTIAL SECTIONAL DOORS: ELEGANCE & SECURITY

European technology at the service of your comfort and the enhancement of your home.

Characteristic	Premium Specification
Safety	Integral anti-pinch and anti-drop device
Insulation	High-density sandwich panels (polyurethane foam ~45 kg/m ³)
Aesthetics	Standard and premium ranges, custom architectural integration
Standard & Reliability	EN 13241 compliant, silent operation



Dock Levelers – Kinematic Precision

A self-supporting structural design engineered to minimize mechanical wear and absorb intense asymmetric shocks (gradient up to $\pm 12.5\%$).



Series 232 M (Hinged Lip)

The ultimate modular solution. Proven mechanical reliability for standard transshipment operations.



Series 233 M (Telescopic Lip)

Millimeter-precise positioning. Ideal for end-of-trailer loads and continuous maintenance of thermal insulation.

Dynamic Capacity: 60 kN / 100 kN
Conformity: European Standard EN 1398 / CE

KIL INDUSTRIE
Automatic Access Systems

Hydraulic Architecture & Active Safety

The invisible engineering that guarantees operational continuity in the most extreme conditions.

Anti-Drop Parachute Valve:
Integrated directly into the main cylinder. Instantly stops the drop if the truck leaves the dock prematurely (insensitive to temperature variations).

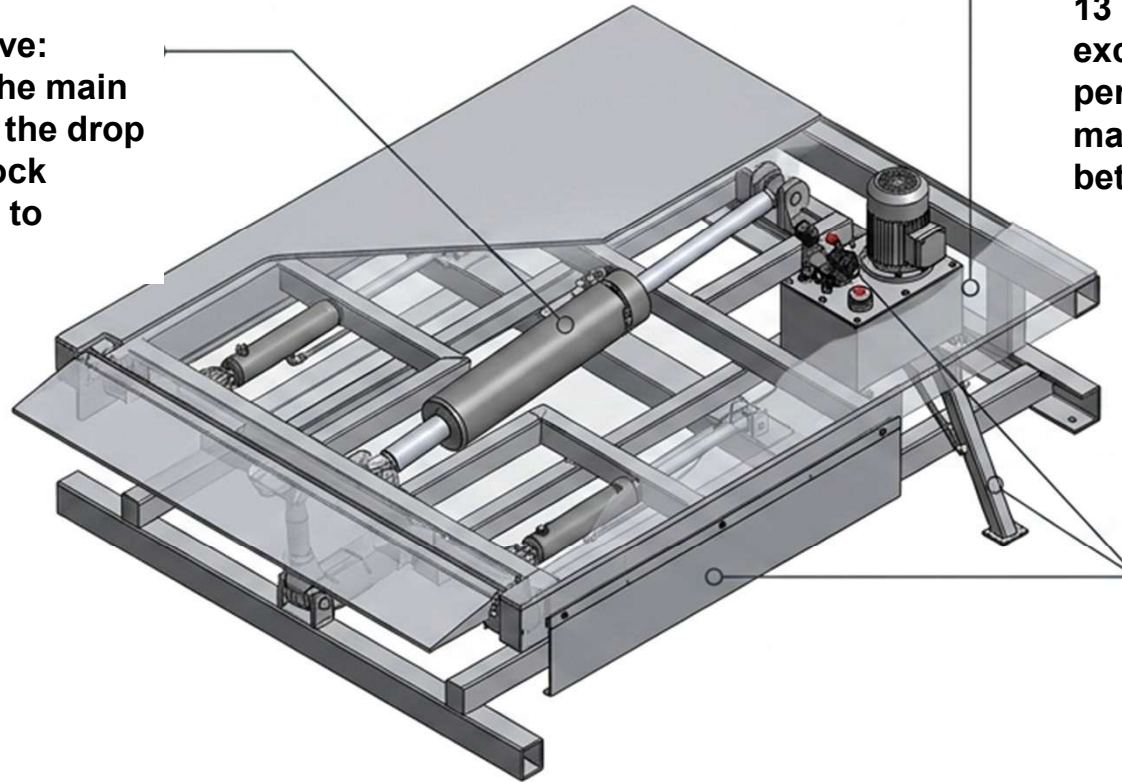

Right top callout — Unavis HVI 13 Vital Fluid: System requiring exclusively this high-performance hydraulic oil to maintain perfect viscosity between -30°C and +50°C

Right top callout — Unavis HVI 13 Vital Fluid: System requiring exclusively this high-performance hydraulic oil to maintain perfect viscosity between -30°C and +50°C

Dock Shelters — The Thermal Shield

Absolute seal between the vehicle and the warehouse to eliminate heat loss and protect goods.

Type 403 (Flexible Shelters)

Superior mechanical resistance.
High tear-resistant reinforced curtains conform to the vehicle body under reversing pressure.



Type 407 (Inflatable for Sub-Zero Environments)

Ultimate insulation in seconds.
Creates an airtight barrier without excessive pressure on the vehicle body.
Automatic retraction post-loading.

ISO CLASS 4 COMPATIBILITY:
The absolute requirement for the cold chain and pharmaceutical industry.

Sectional Doors — High-Performance Closure

Smooth operation combined with uncompromising durability for your most demanding workflows.

40	60	80
ISO 40 mm: The high-quality industrial standard. (U-value: 1.3 to 1.5)	ISO 60 mm: High insulation for controlled environments.	ISO 80 mm: Extreme thermal requirement (Optimal cold chain, U-value: 0.8 to 1.0).



- **Wind Resistance:** Heavy-duty panels and reinforced tracks (Class 3-4, up to 1000 Pa).
- **Heavy-Duty Motorization:** Designed for continuous cycles with optimized opening speed (Zero downtime).

Safety & Accessories — Zero Accident Target

Loading dock operations tolerate no human error. Intelligent interlocking prevents collisions and protects your teams



Shock Absorption

High-resistance bumpers

Vulcanised high-resistance bumpers. Massively absorb initial kinetic energy, preserving the integrity of the civil structure.



Interlocking

Electronic wheel chocks

Smart interlocking: the leveller and the door remain inoperable until the truck is physically secured.



Visual Guidance

LED traffic lights

Clear, instant red/green communication between the driver outside and the forklift operator inside.

Expertise & Systems : INKEMA.

**Industrial Dock & Lifting Solutions.
Specializing in Stainless Steel for
demanding environments.**



INKEMA. ENGINEERING WITHOUT COMPROMISE.

- **+35 Years of Expertise:** Design, manufacturing and installation of complete loading dock solutions.
- **Global Presence:** Active deployment in over 60 countries.
- **Metallurgical Mastery:** CE-certified designs (Machinery Directive 2006/42/CE), elevated by extreme-grade finishes.

> **316L STAINLESS STEEL FINISH:** Absolute corrosion resistance (Pharmaceutical & food industry).

> **HOT-DIP GALVANISING:** Total shield for extreme environments.



DOCK LEVELLERS: PERFECT COMPENSATION.



The Proven Standard

RH1 / RH11 (Tilting lip)

Capacity: 6,000 kg. Hydraulic lip 400 mm.
EN 1398 standard.

CUSTOM RECESS.
(With welded steel pre-frame).



The Precise Extension

RH11/RH13 (Telescopic lip / Heavy load)

Capacity: Up to 15,000 kg (RH13).

MILLIMETRIC TRUCK REACH.



The Spatial Innovation

RH14 (Self-supporting, pit-free)

Surface box model with integrated hydraulic lip.

NO CIVIL WORKS REQUIRED.

LIFT TABLES: SAFE ELEVATION.

— **Anti-fall valve on each cylinder**
(Instant stop in event of rupture).



— **Perimeter safety edge**
(Obstacle detection and descent stop).

— **Mechanical safety bar**
(Physical lock for maintenance).

MEX Series (Heavy-Duty):

Single scissor (MEX1) to Double scissor (MEX2/3/4). Max pressure 180 kg/cm². Up to 120,000 cycles guaranteed before axle replacement.

Eco/Compact Series:

Low-profile for direct integration without heavy excavation. Ideal for assembly lines and confined spaces.

DOCK SHELTERS: ABSOLUTE SEALING.



RETRACTABLE SHELTER (Resilience)

Mechanics: Automatic frame retraction in the event of poor truck maneuvering.

Focus: High-turnover logistics sites requiring maximum durability.

BLACK ANTI-SHOCK STRUCTURE.
Total prevention of structural damage to the facade.



INFLATABLE SHELTER (The Shield)

Mechanics: Dynamic air cushion that perfectly and hermetically seals against the truck body.

Focus: Cold storage warehouses, pharmaceutical industry, strict maintenance of the cold chain.

TOTAL THERMAL SEALING.
Zero energy loss.

BRIDGES & GANGWAYS: THE AGILE LINK.

- **The Strength of Aluminium:** Manual tilting models (Series PA51 to PA54). Unbeatable weight-to-strength ratio and total corrosion resistance for streamlined handling.

- **Mechanical Adaptability:** Rail sliding systems (PAHI / PA61) allowing optimal positioning flexibility along the full length of the dock.

- > **HIGH RESISTANCE:** Extruded structure supporting intensive logistics traffic.

- > **RAPID DEPLOYMENT:** The ideal tool for managing LCVs (Light Commercial Vehicles) and delivery trucks.



ACTIVE SAFETY: THE INKEMA ECOSYSTEM



Details that secure what matters most
Optimizing the professional environment through precision-engineered prevention

Rubber Buffers: High density (1.2 g/cm³), reinforced with a 10 mm steel plate. Maximum absorption of kinetic impact. Wheel Guides: Ø 140 mm galvanized steel tubes.
Electronic Control: Proximity detectors, automated dock chocks, and synchronization with two-color traffic lights.
Forced vehicle alignment and infrastructure protection.

HYDRAULIC ANTI-FALL VALVES: ZERO TOLERANCE

THE INKEMA PROTECTION STANDARD INTEGRATED INTO EVERY LIFTING EQUIPMENT

KIL INDUSTRIE
Systèmes d'accès automatiques

Perk **tek**

Expertise & Systems: **PERKOTEK.**

Biometric Intelligence & Access Control.
Flow management through
next-generation identification.

Biometrics & Facial Recognition Magic Face MF 835 ID



Processor:	400 MHz (Detection < 0.1 second)
Security:	Face • Fingerprint • Card • Password
Connectivity:	Wi-Fi / TCP-IP
Application:	Presence control & Relay triggering

Autonomous Biometric Lock

Magic Pass MP 12370 ID

Absolute architectural integration. No wiring required, access management via onboard intelligence.



Material:	Solid zinc alloy
Sensor:	500 dpi high-precision optical
Capacity:	300 fingerprints / codes
Battery life:	1.5 years (Integrated battery power supply)
Finishes:	Gold, Silver, Black

Vehicle Flow Management

Avax MX6 Barrier System

Industrial robustness for high-volume traffic.
Flawless operation under extreme weather conditions.



Span: Telescopic arm up to 6 meters

Motor Endurance: Tested for 5 million cycles (220V)

Resistance: IP65 rating (Double-layer waterproof enclosure)

Interface: Integrated LED indicators (Red Cross / Green Arrow)

THEY TRUST US



National Excellence, Guaranteed by KIL.

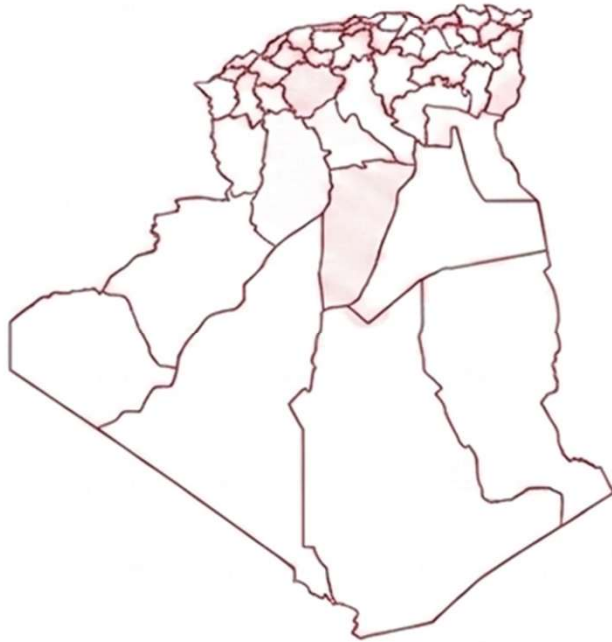

+20

Years of expertise in access engineering in Algeria

58

Wilayas covered by our intervention teams

KIL INDUSTRIE
Automatic access systems

+213 770 307 437 | +213 554 512 900

Your Project Deserves Excellence.

KIL INDUSTRIE is at your disposal for millimeter-precise sizing and integration studies on your future mega-projects.

ENGINEERING OFFICE & SALES DEPARTMENT

Sales Tel: +213 770 307 437

Technical Tel: +213 554 512 900

Web : <https://www.kilindustrie.dz/>

KIL INDUSTRIE
Automatic access systems